

MAYOR STREET UPPER

CASTLEFORBEROARD

NORTH WALL AVENUE

NORTH WALL QUAY

BLOCK A

BLOCK B

BLOCK C

SITE OF CONCURRENT PLANNING APPLICATION AS INDICATED ON DWG No. P0003  
 Note: Footprints of buildings on this adjoining site are for indicative purposes only and are subject to a separate SDZ planning application

NOTE  
 ALL DIMENSIONS TO BE CHECKED ON SITE  
 NO DIMENSIONS TO BE SCALED FROM THIS DRAWING  
 THIS DRAWING IS TO BE READ IN CONJUNCTION WITH RELEVANT CONSULTANTS DRAWINGS  
 ANY PROPOSALS EXTERNAL TO THE REDLINE ARE INDICATIVE ONLY.

- █ SHD Planning Application Boundary
- █ Other lands in ownership of the Applicant
- 1 Bedroom apartment
- 2 Bedrooms apartment

NOTE:  
 - LEVELS SHOWN RELATE TO OS DATUM LEVELS

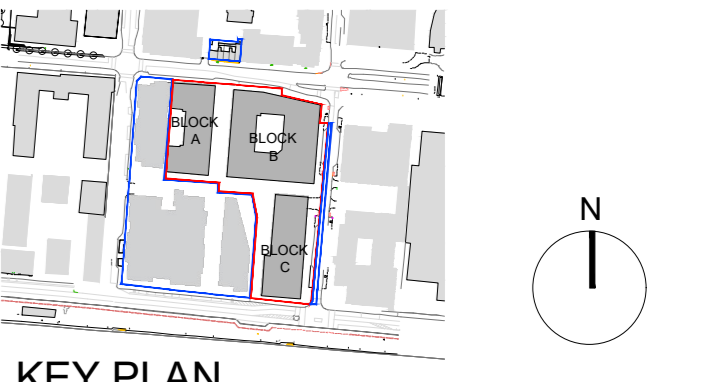

KEY PLAN

NOTE  
 ALL DIMENSIONS TO BE CHECKED ON SITE  
 NO DIMENSIONS TO BE SCALED FROM THIS DRAWING  
 THIS DRAWING IS TO BE READ IN CONJUNCTION WITH RELEVANT CONSULTANTS DRAWINGS

REV	DATE	DESCRIPTION	CHKD	DRN
7	15/01/2021	SHD Planning Application	GC	NP
6	08/01/2021	DRAFT SHD Planning Application	GC	NP
5	27/05/2020	ABP Response Issue	GC	NP
4	24/04/2020	Issued for information	GC	NP
3	28/11/2019	SHD Consultation Request	GC	NP
2	21/11/2019	DRAFT SHD Submission	GC	NP
1	12/11/2019	DRAFT SHD Submission	GC	NP

APPLICATION REFERENCE NO.: ABP-306158-19  
**PLANNING**

**Henry J Lyons**

Architecture + Interiors +353 1 888 3333 51-54 Pearse Street  
 henryjlyons.com info@henryjlyons.com Dublin D02 KA66

CLIENT  
**Waterside Block 9  
 Developments Limited**  
 PROJECT  
**Waterfront ~South Central~  
 SHD Scheme**

JOB NUMBER: 950527  
 DATE: January 2021  
 SCALE: 1:200 @A0  
 DRAWN: NP  
 CHECKED: GC  
 FILE NAME: P 1039 Twenty Ninth Floor Plan

DRAWING  
**Twenty Ninth Floor Level 29**

BLOCK	DRAWING NUMBER	ZONE	REVISION
	<b>P1039</b>		<b>7</b>